

# 719 Hoover Mill Rd.

WOODBURY, TENNESSEE 37190



developments | real estate | construction  
615-896-0000



## TRAFFIC COUNT

• 2,858 Hwy 64  
• 13,674 U.S.-70S

**Acres:** 23.82 +/-  
**Structures:** N/A  
**Amenities:** N/A  
**Road Frontage:** 829 ft. +/-  
**Property Type:** Land  
**Zoning:** Residential

## PROPERTY HIGHLIGHTS

- 2 lots - 9.2 acres and 14.62 acres
- Highway corner and view
- Conveniently located off U.S.-70S
- Easy Access to U.S.-70S
- Approx. 1 hour to Nashville Airport

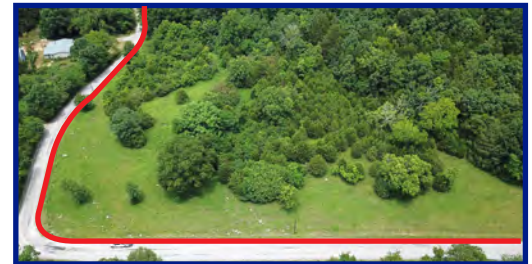

## DEMOGRAPHIC SNAPSHOT

### CANNON COUNTY

2024 Population Estimate	15,319
2024 Median HH Income	\$58,092
2024 Number of Households	5,686

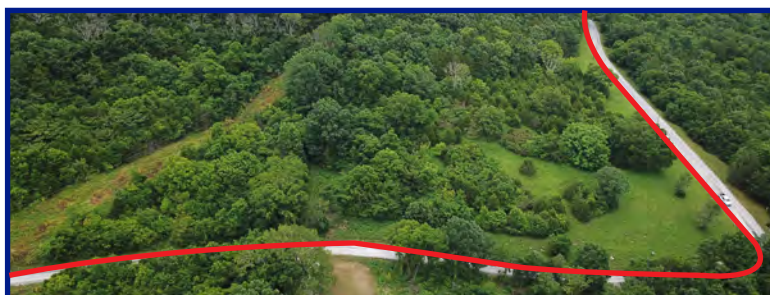

**615-896-0000**

[www.swansondevelopments.com](http://www.swansondevelopments.com)

The information herein has been obtained from sources believed to be reliable. There is no guarantee, warranty or representation that the information herein is accurate. Any projections, opinions, assumptions, or estimates used are for example only and do not represent the current or future performance or value of the property. Property location imagery provided by Google Maps.

03/25